



# INSTRUCTION BULLETIN

No. 340137  
Machine: 4300  
Published: 12-98/00  
System: OPTIONS

**NOTE: DO NOT DISCARD the Parts List from the Instruction Bulletin. Place the Parts List in the appropriate place in your machine manual for future reference. Retaining the Parts List will make it easier to reorder individual parts and will save you the cost of ordering an entire kit.**

*NOTE: Numbers in parenthesis ( ) are reference numbers for parts listed in Bill of Materials.*

Installation instructions for kit number 367644

## **SYNOPSIS / PROBLEM:**

This kit contains the parts needed to install revolving light kit on the model ATLV 4300. Please follow step-by-step instructions.

## **SPECIAL TOOLS / CONSIDERATIONS: NONE**

(Estimated time to complete: 1hour)

## **PREPARATION:**

(Refer to FIG. 1, 2 and 3)

**FOR SAFETY: Before leaving or servicing machine, stop on level surface and set parking brake. Then turn off machine and remove key.**

1. Disconnect battery cables from machine.



**WARNING: Always disconnect battery cables from machine before working on electrical components.**

## **INSTALLATION:**

(Refer to FIG. 1, 2 and 3)

1. Mount light assembly mounting bracket (3) to left hopper hinge with hinge mounting hardware. (Refer to FIG. 1 and 2)
2. Install rubber grommet (2) in assembly mounting bracket (3). (Refer to FIG. 1)
3. Run revolving light wire from main wiring harness up the mounting bracket (3), through the rubber grommet (2) and wire into lamp assembly (1). (Refer to FIG. 1 and 2)
4. Mount lamp assembly (1) to light assembly mounting bracket (3) with hex screws (4), nuts (5) and washers (6).
5. Connect battery cables to machine.
6. Turn machine on, and check warning light for proper operation. (Operating/Hazard light switch is prewired, and located on the panel to the left of the operator's seat.)

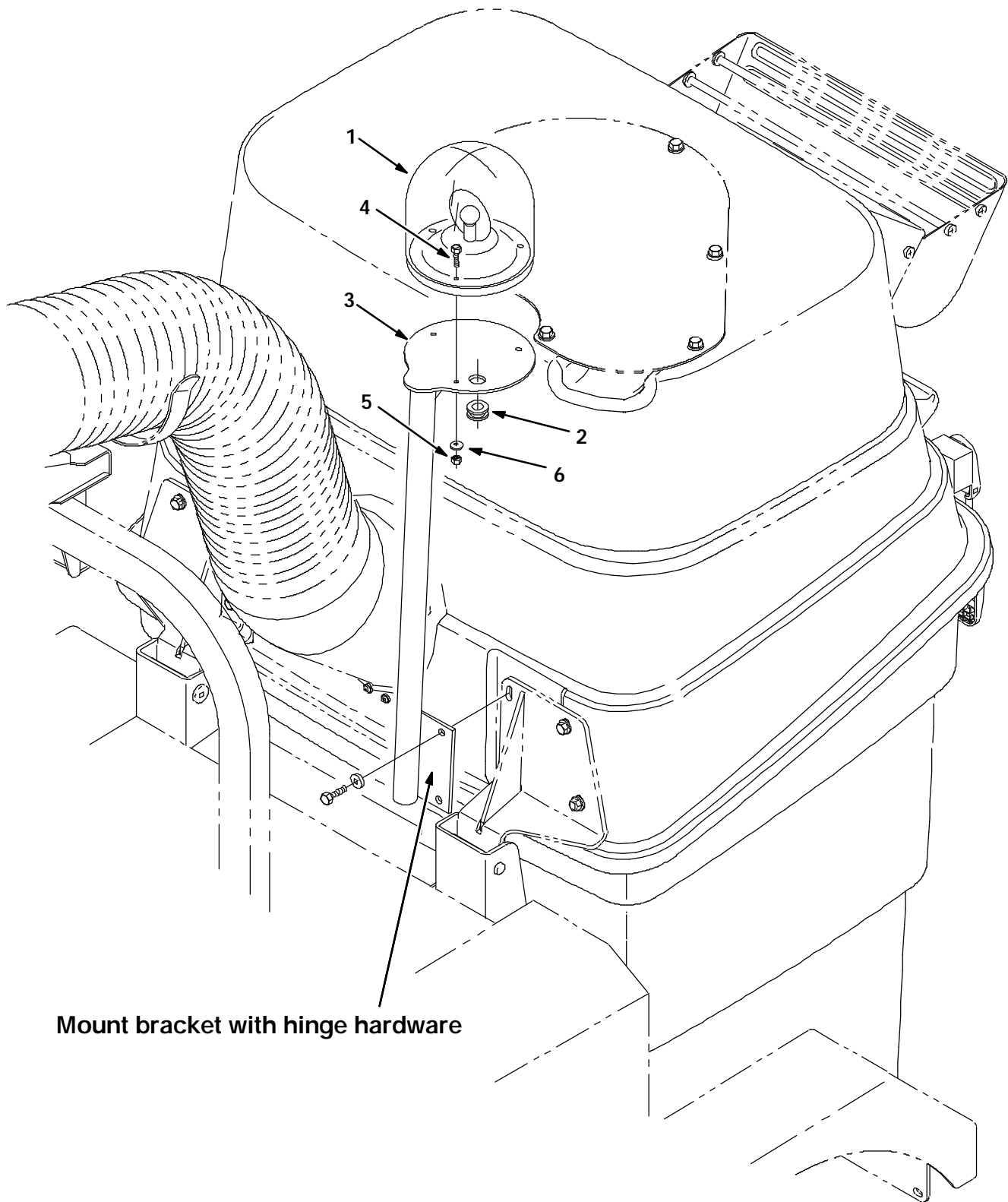

**FIG. 1 - REVOLVING LIGHT KIT INSTALLATION**

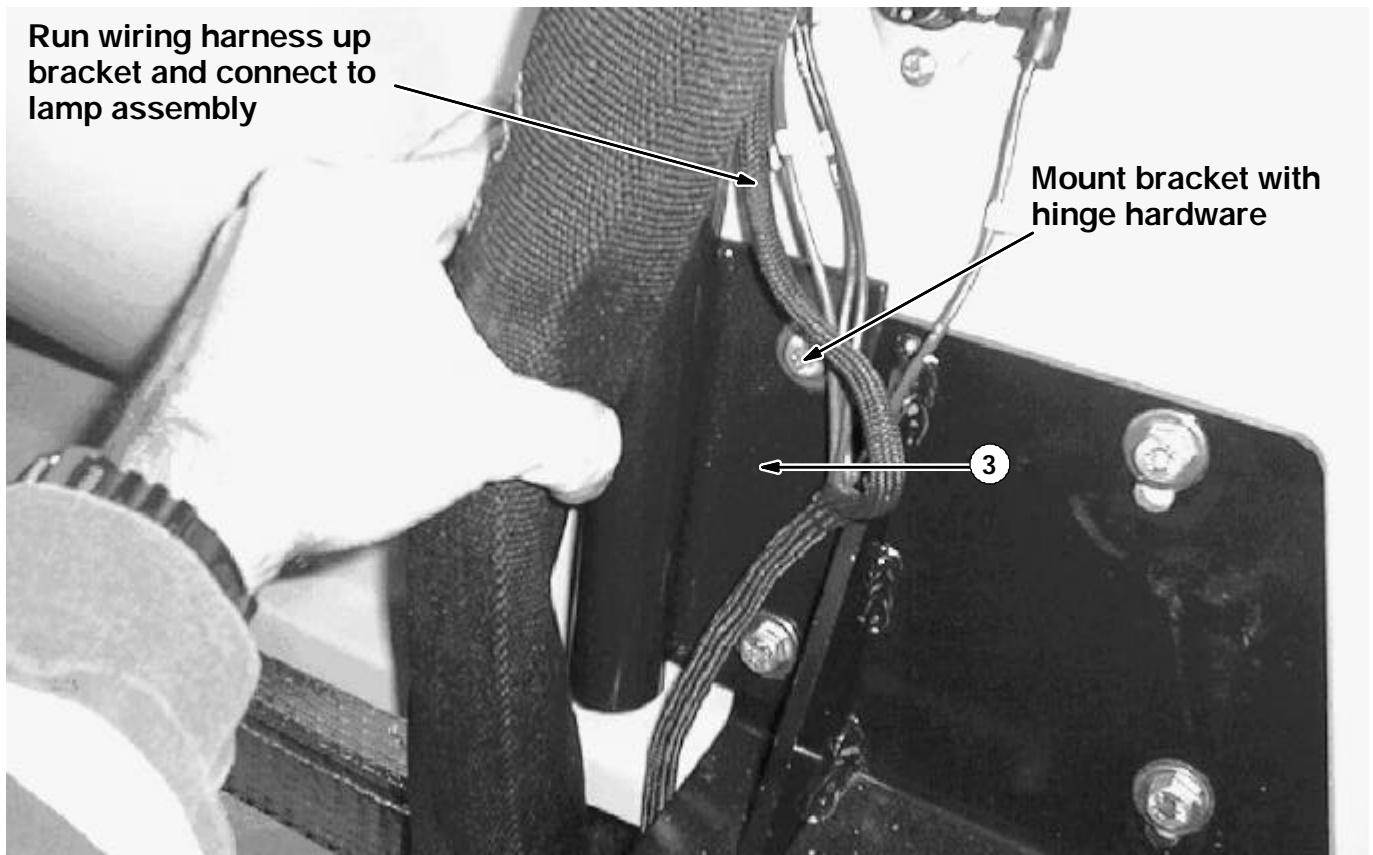

**FIG. 2 - MOUNTING LIGHT BRACKET**

**BILL OF MATERIALS FOR REVOLVING LIGHT LIT 367644**

Ref.	TENNANT Part No.	Description	Qty.
1	768598	Lamp assy, rotating, halogen, amb	1
2	10632-9	Grommet, rbr, 0.56ID, for .13matl	1
3	367765	Bracket assy, light mtg.	1
4	12316	Scr hexss M5 X 0.8	3
5	07784	Nut, HX std, ss M5 X 0.8	3
6	01684	Washer, flt .25 ss	3

TENNANT COMPANY  
P. O. Box 1452  
Minneapolis, MN 55440-1452